

Pedestrian footways affected by CH8 signage will maintain a walkway of 1.2 metres minimum. Cones will be used with any signage that is placed in the carriageway and all signs will be suitably weighted.

Shuttle lane running will be a minimum of 3.25 metres

Footway to be 1.2m minimum

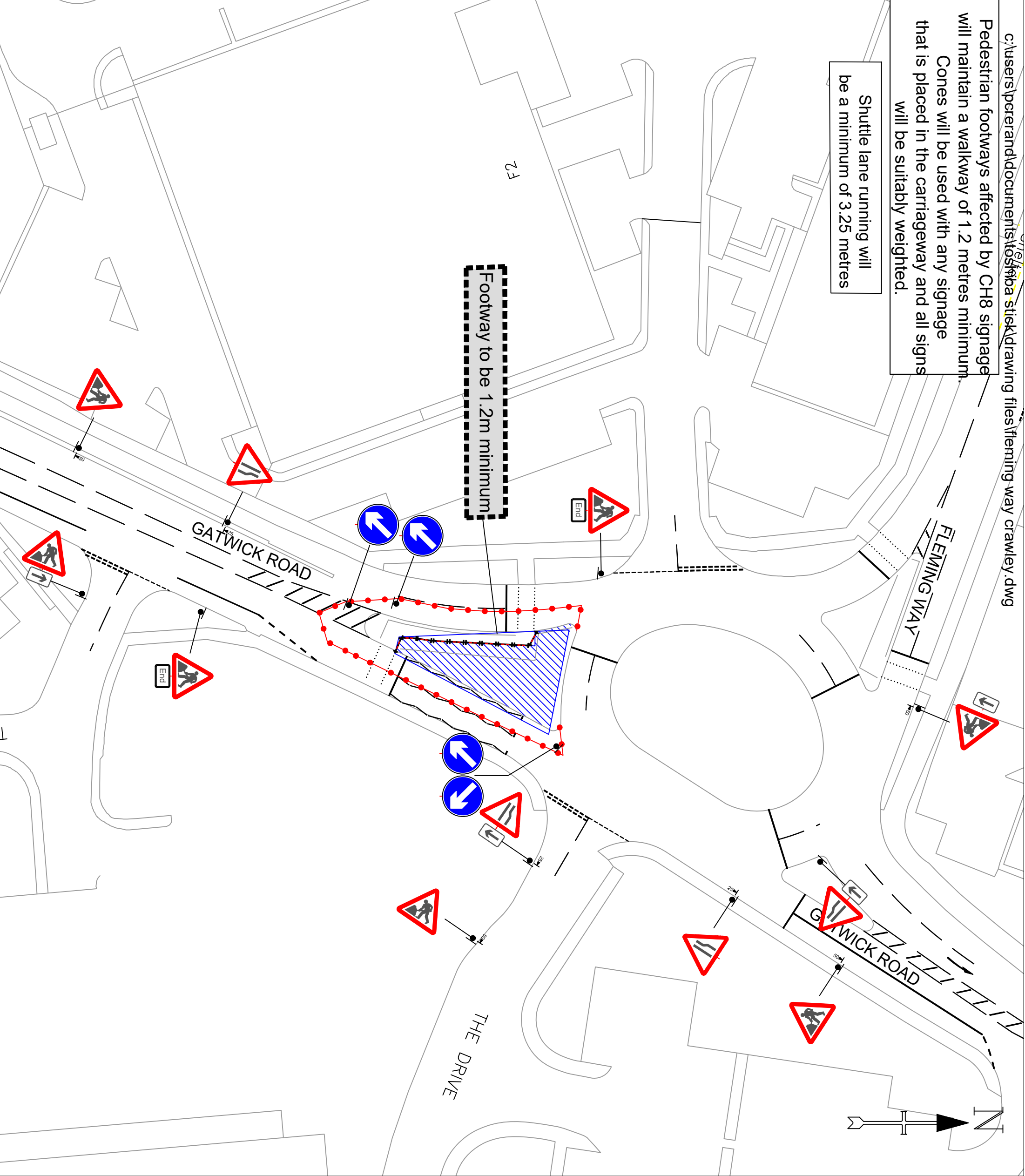

Additional Information:  
 All drawings are compliant with  
 Safety at Street Works  
 and Road Works  
 A Code of Practice

Drawing Keys:  
**KEY**

- Traffic sign
- Traffic cone
- Traffic signals to Diagram 3000.1
- Working Space
- Safety Zone
- Pedestrian Barrier

**SAFETY ZONE DIMENSIONS** (S)  
 Permanent speed limit 30mph or less  
 Sideways safety zone 0.5m  
 Longways safety zone 0.5m  
 (Dimensions are minima)

Client:  
**Hobart**  
 Paving & Civil Engineering

Type of works: Resurfacing Works  
 Title of Scheme/Project: 278 works  
 Fleming Way Roundabout Nexus

Name of drawing: Fleming Way Roundabout Crawley  
 Speed limit of road:

Drawing Number: Boro-AL-287-Phase 4

Date Drawn:	05/10/20	Date Checked:	05/10/20	Date Approved:	05/10/20
Drawn by:	Paul Cierand	Checked by:	James Ward	Approved by:	Simon Carrim
Current revision	2	See previous revisions below.			

Rev	Details	Date
1	Tm Signage Added Phase 4	05/10/20
2	Tm Signage Added Phase 4	19/11/20

Original Drawing size	A3	Scale	NTS
-----------------------	----	-------	-----

This drawing is the property of the H W Martin group of companies, no part of this drawing may be reproduced in any form without prior permission.